

EpinephrineSnap™-V

Epinephrine convenience kit

Rx Only

NDC 71923-200-20

epinephrine**snap**-v™
EPINEPHRINE CONVENIENCE KIT

Single use only

For intramuscular or subcutaneous use

Not for intravenous or ophthalmic use

Indicated for patients weighing greater than or equal to 15 kg (33 lbs)

Keep out of reach of children

Store at 20 to 25 degrees C (68 to 77 degrees F)

Indications and Use

The epinephrine in this kit is a non-selective alpha and beta adrenergic agonist indicated for the emergency treatment of allergic reactions, including anaphylaxis.

Dosage and Administration

Always follow the prescriber's order for dosing and administration. Epinephrine may be administered for anaphylaxis:

Adults and Children 30 kg (66 lbs.) or more 0.3 to 0.5 mg (0.3 to 0.5 mL) of undiluted epinephrine administered intramuscularly or subcutaneously in the anterolateral aspect of the thigh, up to a maximum of 0.5 mg (0.5 mL) per injection, repeated every 5 to 10 minutes as necessary. Monitor clinically for reaction severity and cardiac effects.

Children 15-30 kg (33-66 lbs.) 0.01mg/kg (0.01 mL/ kg) of undiluted epinephrine administered intramuscularly or subcutaneously in the anterolateral aspect of the thigh, up to a maximum of 0.3 mg (0.3 mL) every 5 to 10 minutes as necessary. Maximum single dose is 0.3 mg (0.3 mL) per injection, repeated every 5 to 10 minutes as necessary. Monitor clinically for reaction severity and cardiac effects.

The Epinephrine Syringe™ does not have markings of less than 0.15 mL, or the equivalent of a dose of 0.15 mg.

Monitor patient clinically for the severity of the allergic reaction and the potential cardiac effects of the drug, with repeat doses titrated as necessary. *

See epinephrine full prescribing information at parsterileproducts.com

Product Information

EpinephrineSnap™-V is an epinephrine convenience kit designed for use by licensed health care professionals authorized to administer prescription medication.

Each kit is designed to treat a single episode of an allergic reaction/anaphylaxis. The epinephrine provided in this kit must be used on the patient experiencing signs and symptoms of an allergic reaction/anaphylaxis or discarded in an appropriate sharps container within 30 minutes of entering the epinephrine vial. Prepared syringes may not be stored for later use.

Each EpinephrineSnap™-V kit contains

- (1) Vial of epinephrine injection
1:1000 1 mg/ mL for intramuscular or subcutaneous use
- (1) Epinephrine package insert
- (4) Alcohol Prep Pads
- (3) 23-gauge 1-inch safety needles
- (3) 1 mL Luer lock Epinephrine Syringes™ with markings of 0.15 mL, 0.3 mL and 0.5 mL
- (1) Instructions For Use card

Epinephrine is light sensitive; protect from light and freezing.

See epinephrine package insert for INDICATIONS, and USAGE, CONTRAINDICATIONS, WARNINGS, PRECAUTIONS, ADVERSE REACTIONS and OVERDOSAGE.

Instructions for Use

Remove inner tray from outer packaging, place on a flat surface. Remove the epinephrine vial. Inspect the epinephrine vial for particulate matter and discoloration prior to administration. Do not use if the solution is colored or cloudy or if it contains particulate matter. Snap off the lid of the epinephrine vial and wipe the rubber stopper with an alcohol prep pad.

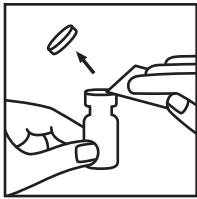

Remove the safety needles and The Epinephrine Syringe™. Attach a safety needle to a syringe and insert needle through the rubber stopper of the epinephrine vial, drawing out a single dose.

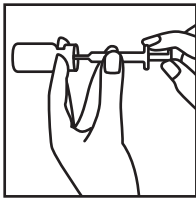
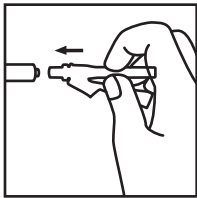

Always follow the prescriber's order for dosing information.

Prepare to administer the subcutaneous or intramuscular injection. The preferred site of epinephrine administration is the anterolateral aspect of the thigh (vastus lateralis muscle) because of its location, size and available blood flow. This location is between the greater trochanter and the knee. When injecting, lift the vastus lateralis muscle away from the bone. Cleanse the site of administration with an

alcohol pad prior to injection, however, epinephrine may be injected through clothing if necessary.

Do not inject into the buttocks, digits, hands or feet.

If the patient's symptoms of anaphylaxis persist, epinephrine dosing may be repeated every 5-10 minutes per the prescriber's order.

Do not administer repeated injections of epinephrine in the same site as the resulting vasoconstriction will cause tissue necrosis.

Any unused epinephrine either in the vial or syringes must be discarded 30 minutes after entering the vial.

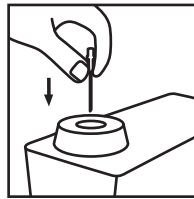

[*parsterileproducts.com/products/assets/pdf/PI/2018/Adrenalin-PI-2018.pdf](http://parsterileproducts.com/products/assets/pdf/PI/2018/Adrenalin-PI-2018.pdf)

You are encouraged to report negative side effects of prescription drugs to the FDA.

Visit [fda.gov/ Safety/MedWatch/](http://fda.gov/Safety/MedWatch/) or call 1-800-FDA-1088

For more information, go to snapmedicalindustries.com

Snap Medical Industries
545 Metro Place South Suite 100
Dublin, Ohio 43017

Phone: 1-800-875-4508

EpinephrineSnap™-V IFU | 06/2019